

## PARTS IDENTIFICATION

1. 'Jaws' Section
2. Wheel Hub Cover Arm
3. Male Lock Portion
4. Female Lock Portion
5. Hex Tool
6. Lock Cap
7. Wheel Hub Arm Hex Bolt
8. 'Jaws' Section Hex Bolt
9. Key (x3)

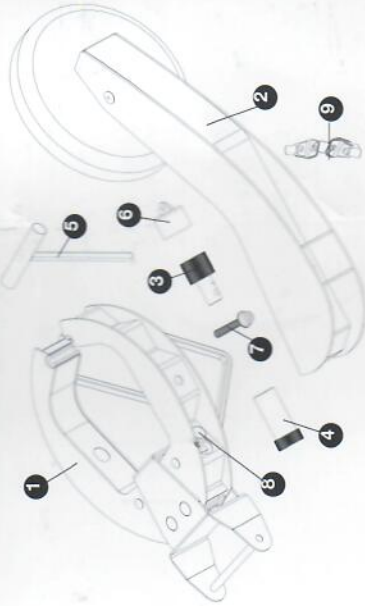

Please store your keys in a safe place and remember to register your product. Registration is quick and simple, go to [www.purpleline.co.uk/product-registration](http://www.purpleline.co.uk/product-registration) Please register within 14 days of purchase. Please retain your original purchase receipt.

## INSTALLATION



A. Using the hex tool (5), unscrew the hinge bolt (8) anti-clockwise to open the 'jaws' (1).

B. Check that the 'jaws' open enough to fit around the tyre and then fit the 'jaw' section around the wheel.



NOTE: The tips of the 'jaws' should be fitted into the wheel as far as possible. A little experimentation will be required to ensure a secure fit for your application.



C. Once the optimum jaw position has been established, the jaws need to be closed by using the hex tool to turn the hinge bolt clockwise. Use the hex tool to achieve a secure fixing.

TIP: When fitting to alloy wheels it may be prudent to use some form of padding to protect the wheel from being scratched.



F. Feed the arm over the hex bolt.



G. Slide the arm into the slot.

D. If necessary, unscrew (by turning anti-clockwise) the Wheel Hub Arm Hex Bolt (7). Do not fully remove.

E. The Wheel Hub Cover Arm (2) has a 'key hole' slot that fits over the hex bolt.

NOTE: With certain wheels it is sometimes easier to unscrew the hex bolt from the 'jaw' section, locate through the 'key hole' aperture (see 7a) in the arm and then offer up the arm to locate the end of the hex bolt into the thread.



H. Hold the arm in position. The round wheel cover has a slide and fit mechanism and should be adjusted to be central to the face of the wheel as much as possible. On larger wheels where central location is not possible, it must be ensured that at least one of the wheel nuts is covered.



J. Insert the Female Lock Portion (4) into the apertures of the lock cradle on the wheel cover arm. Insert the Male Lock Portion (3) into the female lock portion and secure with the key (9).



NOTE: The male portion has a notch that locates into a recess on the female portion.

TIP: Best practice is to have the male lock portion (3) through the left aperture of the lock cradle and the female lock portion (4) through the right aperture of the lock cradle for optimum security.

## MAINTENANCE

Grease the lock face and ball bearings before first use, with a light oil such as 3-IN-ONE or equivalent.

Thereafter spray any moving parts of the lock body with a light oil such as 3-IN-ONE or equivalent every eight weeks.